

User Manual Grenton Intercom Monitor 7"

ICM-002-E-01

Grenton Intercom Monitor is a 7-inch internal video intercom with an IPS screen at a resolution of 1024x600. It enables connection of alarm sensors and doorbell.



1. Technical Data

Display	7" IPS LCD, capacitive
Power supply	PoE, 12V _{dc}
Power consumption	6W, in standby - 2.5W
Built-in camera	No
Screen resolution	1024 x 600
Body	Aluminum
Dimensions (H/W/D)	128/236/26,5mm
Installation	Wall mount, Flush mount with a special bracket

2. Mechanical Mounting

Before mounting the monitor, it is necessary to prepare a hole or recess in the wall with dimensions of 222/114/60mm (for flush mounting). It is necessary for switching of wires and installation of the monitor.

Attach the bracket in the outlet box using set screws and a phillips head screwdriver. Installation of the monitor on the bracket is done from top to bottom.

Wall mounting:

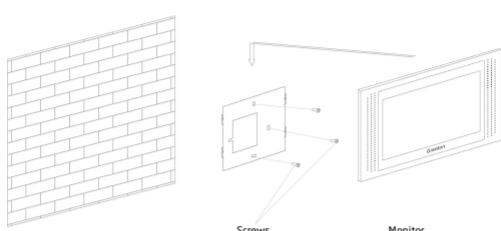

Flush mounting with a special bracket:

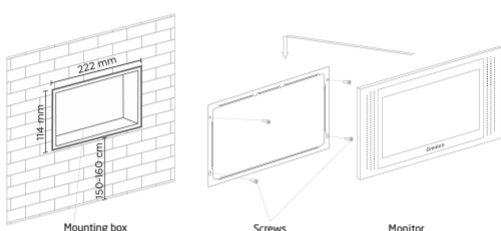

3. Wiring diagram

To connect monitor you will need:

- An Ethernet UTP CAT5 or higher cable connected to a PoE network switch or regular switch / router (the maximum length of the UTP CAT5 cable segment should not exceed 100 meters, according to the IEEE 802.3 standard).

- Power supply at 12V, 2A.
- If additional inputs of the monitor are required, the appropriate number of signal cables should be routed as needed.

Connecting the doorbell to the monitor:

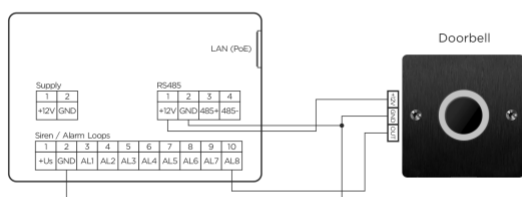

4. Warnings and Cautionary Statements



ATTENTION!

- Before proceeding with the assembly, read the installation schematics and full instructions available at www.grenton.com. Failure to follow the guidelines contained in the instructions and other requirements of due care valid as a result of the nature of the equipment (device) may be dangerous to life / health, damage the device or installation to which it is connected, damage other property or violate other applicable regulations. The manufacturer of the device, Grenton Sp. z o. o. does not bear any responsibility

for the damage (property and non-property related) resulting from the assembly and / or use of the equipment and / or in accordance with the instructions and / or due diligence in handling the equipment (device).

- Device power supply, permissible load or other characteristic parameters have to be in accordance with the device specification, described in particular in the "Technical data" section.
- The product is not intended for children and animals.
- If you have technical questions or comments about the device operation, contact Grenton Technical Support.
- Answers to frequently asked questions can be found at: www.support.grenton.pl



DANGER!

- Danger to life caused by electric current!
- The components of the installation (individual devices) are designed to work in a home

electrical installation or directly in its vicinity. Incorrect connection or use may cause a fire or electric shock.

- All work related to the installation of the device, in particular works involving interference in the electrical installation, may be performed only by a person with appropriate qualifications or licences.
- When installing the device, make sure that the power supply voltage is disconnected from the circuit in which the device is connected or near which the assembly takes place.

5. CE Marking

The full manufacturer declares that the device in full compliance with the requirements of EU legislation that includes the directives of a new approach appropriate for this equipment. In particular, Grenton Sp. z o. o. declares that the device fulfills the requirements on safety, specified by law, and that it conforms to the

national regulations that implement the appropriate directives: The Radio Equipment Directive (RED - 2014/53/UE), the Low Voltage Directive (LVD 2014/35/UE) and the Directive on the limitation of the use of specific substances in electrical and electronic equipment (RoHS II - 2011/65/UE).



6. Warranty

Warranty available at: www.grenton.com/warranty

7. Manufacturer Contact Details

Grenton Sp. z o.o.
ul. Na Wierzchowinach 3
30-222 Kraków, Poland
www.grenton.com