



Door & Window Sensor

user manual



Please read the user manual carefully before operating.
Please keep the user manual for future reference.



Product Introduction

Infibity Door & Window Sensor is a wireless (Z-Wave) sensor that detects opening and closing of a door, window, gate, etc. and is compatible with the Grenton Smart Home system. The module can be powered by batteries or via a USB port, it has compact dimensions and can be easily installed on a door or window. To use the module in the Grenton Smart Home system, you need to add it to the Grenton CLU Z-Wave central unit. The sensor, once added to the system, sends information every time its state changes, for example, when a window is opened or closed. Additionally, the device is equipped with a temperature and humidity sensor.

The device can also be used with any other Z-Wave controller and can realize associations with other Z-Wave devices. Please refer to our website www.infibity.com for more information.

Technical Parameters

Power	CR123 x1
USB power	5V / 1A
Standby current	8µA
Operating current	Up to 15mA
Operational temperature	0-45°C
Radio frequency	868.4MHz EU
Range	Up to 45m indoors (depending on the building structure), up to 80m outdoors
Size (L x W x H)	Main body: 82 x 27 x 23mm Deputy body: 50 x 13 x 16mm

Product elements

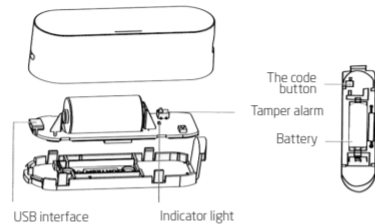

Items list

Door sensor main body	1 pc
Door sensor deputy body	1 pc
Battery	1 pc
Screw	4 pcs
Screw stopper	4 pcs
Sticker	2 pcs
User manual	1 pc
USB cable	1 pc

Installation Steps

1. Door Sensor Installation

Option 1

Disassemble the door sensor main body, remove the battery, and fix it on the door using screws. Disassemble the door sensor deputy and fix it on the corresponding door frame position.

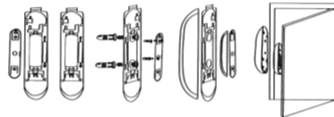

Option 2

Put the sticker on the bottom of the door sensor, then fix it to the appropriate surface.

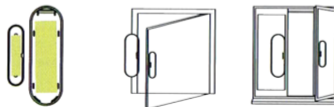

NOTE: When installing the door sensor, the door sensor deputy body must be installed on the bulge side of the door sensor main body.

2. Battery Installation

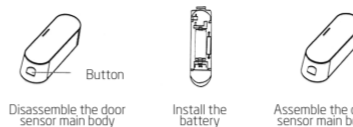

Tips

- When installing the door sensor, the distance between the main body and the deputy body should be less than 2cm.
- If the distance between the main body and the deputy body is less than 2cm, the sensor returns a status indicating closure.
- If the distance between the main body and the deputy body is greater than 2cm, the sensor returns a status indicating opening.

The status of LED

Color	LED Status	Description
Red	Light On 1s when Power On	Not added to the Z-Wave network
	Blink One Time	Open status signal
	Fast Blinks	Cover is Removed
Green	Light On 1s when Power On	Added to the Z-Wave network
	Blink One Time	Close status signal
Cyan	Blink One Time	Cover is Closed
White	Light On 2s	Waiting time
Blue	Blink with 1s Interval	Add to Z-Wave network
	Blink with 500ms Interval	Remove from Z-Wave network
Pink	Light On 2s	Waiting time

Configuration

Add Door Sensor to Z-Wave Network

- Disassemble the main body of the sensor and install the battery.
- Set your Z-Wave controller into inclusion mode.
- Press and hold the button on the sensor for 5s until the white LED lights up. The module will enter inclusion mode - the blue LED will start blinking every 1s.
- The green LED will light up for 1s at the end of the Inclusion process.

When using a Z-Wave controller based on the S2 security protocol, it may be necessary to enter the DSK password. It can be found on the casing or packaging along with the Z-Wave QR code.

The device supports SmartStart function. No further action is required and the SmartStart product will be added automatically within 10 minutes of being switched on in the network vicinity. Make sure that the Z-Wave controller is also equipped with the SmartStart feature.

NOTE: Upon sending the configuration to the CLU Z-Wave controller, if you change the ZWAVE_WAKEUP->Interval parameter, press the button on the sensor to wake it up and save the settings.

Remove Door Sensor from Z-Wave Network

- Make sure the door sensor is powered on.
- Set your Z-Wave controller into exclusion mode.
- Press and hold the button on the sensor for 5s until the white LED lights up. The module will enter exclusion mode - the blue LED will start blinking every 500ms.
- The red LED will light up for 1s at the end of the Exclusion process.

Restore Door Sensor to Factory Default Settings

- Disassemble the main body of the sensor.
- Make sure the door sensor is powered on.
- Press and hold the button on the sensor for 10s until the pink LED lights up.
- Release the button.

Device Application

The device is not intended for use in any security systems. Data from the device is for informational purposes only and may contain inaccuracies. Under no circumstances shall Grenton Sp. z o.o. be liable for damages arising from the use of the device and/or information provided by Grenton Sp. z o.o. contrary to its intended purpose.

More information

More information can be found on the website www.infibity.pl/manuals.

Warranty

The warranty is available at: www.infibity.com/warranty.

Company data

Grenton Sp. z o.o.
ul. Na Wierzchowinach 3
30-222 Kraków, Poland
support@infibity.com
+48 12 2002 606