



# Motion Sensor

## user manual



Please read the user manual carefully before operating.  
Please keep the user manual for future reference.



### Product Introduction

Infibity Motion Sensor is a wireless (Z-Wave) sensor that allows motion detection using a passive infrared (PIR) sensor and is compatible with the Grenton Smart Home system. The module can be powered by batteries or via a USB port. To use the module in the Grenton Smart Home system, you need to add it to the Grenton CLU Z-Wave central unit. The sensor, once added to the system, sends information every time its state changes, e.g. when motion is detected. Additionally, the device is equipped with a temperature, humidity and light sensor.

The device can also be used with any other Z-Wave controller and can realize associations with other Z-Wave devices. Please refer to our website [www.infibity.com](http://www.infibity.com) for more information.

### Technical Parameters

Power	CR123A 3V x2
Standby current	38µA
Operating current	15mA
Operational temperature	0-40°C
Detection range	10m
Field of View	120°
Radio frequency	868.4MHz EU
Range	Up to 30m indoors (depending on the building structure), up to 50m outdoors
Size (L x W x H)	68 x 56 x 56mm

### Product elements

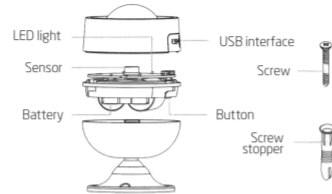

### Items list

Motion sensor	1 pc
Battery	2 pcs
Screw	2 pcs
Screw stopper	2 pcs
Sticker	1 pc
User manual	1 pc
USB cable	1 pc

### Installation Steps

#### 1. Motion Sensor Installation

##### Option 1

Remove the sensor casing and disassemble the bracket. Attach the bracket in the appropriate position to the surface using screws. Reassemble the entire unit.



##### Option 2

Put the sticker on the bottom of the motion sensor, then fix it to the appropriate surface.



#### 2. Battery Installation



Disassemble the motion sensor main body

Install a batteries

Assemble the motion sensor main body

### Working Conditions

If motion is detected within the detection area, the sensor triggers a motion detection signal and signals it with a blink of a pink LED.

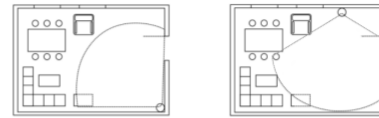

### Tips

- PIR is recommended to be fixed at a height of 2-4 meters off the ground.
- When installing the PIR, please keep it far away from places where air temperature changes sensitively, e.g., around air conditioners or refrigerators.
- Make sure the motion sensor is placed in the Z-Wave network range.

### The status of LED

Color	LED Status	Description
Red	Light On 1s when Power On	Not added to the Z-Wave network
	Fast Blinks	Cover is Removed
Green	Light On 1s when Power On	Added to the Z-Wave network
Cyan	Blink One Time	Cover is Closed
White	Light On 2s	Waiting time
Blue	Blink with 1s Interval	Add to Z-Wave network
	Blink with 500ms Interval	Remove from Z-Wave network
Pink	Light On 2s	Waiting time
	Blink One Time	Motion is Detected

### Configuration

#### Add Door Sensor to Z-Wave Network

- Disassemble the main body of the sensor and install the battery.
- Set your Z-Wave controller into inclusion mode.
- Press and hold the button on the sensor for 5s until the white LED lights up. The module will enter inclusion mode - the blue LED will start blinking every 1s.
- The green LED will light up for 1s at the end of the Inclusion process.

When using a Z-Wave controller based on the S2 security protocol, it may be necessary to enter the DSK password. It can be found on the casing or packaging along with the Z-Wave QR code. The device supports SmartStart function. No further action is required and the SmartStart product will be added automatically within 10 minutes of being switched on in the network vicinity. Make sure that the Z-Wave controller is also equipped with the SmartStart feature.

**NOTE:** Upon sending the configuration to the CLU Z-Wave controller, if you change the ZWAVE\_WAKEUP->Interval parameter, press the button on the sensor to wake it up and save the settings.

#### Remove Door Sensor from Z-Wave Network

- Make sure the sensor is powered on.
- Set your Z-Wave controller into exclusion mode.
- Press and hold the button on the sensor for 5s until the white LED lights up. The module will enter exclusion mode - the blue LED will start blinking every 500ms.
- The red LED will light up for 1s at the end of the Exclusion process.

#### Restore Door Sensor to Factory Default Settings

- Disassemble the main body of the sensor.
- Make sure the sensor is powered on.
- Press and hold the button on the sensor for 10s until the pink LED lights up.
- Release the button.

### Device Application

The device is not intended for use in any security systems. Data from the device is for informational purposes only and may contain inaccuracies. Under no circumstances shall Grenton Sp. z o.o. be liable for damages arising from the use of the device and/or information provided by Grenton Sp. z o.o. contrary to its intended purpose.

### More information

More information can be found on the website [www.infibity.pl/manuals](http://www.infibity.pl/manuals).

### Warranty

The warranty is available at: [www.infibity.com/warranty](http://www.infibity.com/warranty).

### Company data

Grenton Sp. z o.o.  
ul. Na Wierzchowinach 3  
30-222 Kraków, Poland  
support@infibity.com  
+48 12 2002 606